



## SCHOTTKY BARRIER RECTIFIERS

### FEATURES

- High breakdown voltage
- Low turn-on voltage
- Guard ring construction for transient protection

### MECHANICAL DATA

- Case: SOD-323FL
- Terminals: Solderable per MIL-STD-750, Method 2026
- Approx. Weight: 4.5mg / 0.00016oz

### PINNING

PIN	DESCRIPTION
1	Cathode
2	Anode

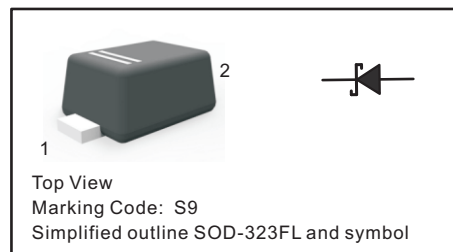

### Maximum Ratings at 25 °C

Parameter	Symbols	BAT46WFL	Units
Maximum Repetitive Peak Reverse Voltage	$V_{RRM}$	100	V
Working peak reverse voltage	$V_{RWM}$	100	V
Continuous Forward Current	$I_F$	150	mA
Repetitive peak forward current (Note 1) @ $t_p < 1.0s$ , Duty Cycle $< 50\%$	$I_{FRM}$	350	mA
Non-repetitive Peak Forward Surge Current at 8.3ms	$I_{FSM}$	25	A
Power Dissipation	$P_D$	200	mW
Thermal resistance junction to ambient air	$R_{thJA}$	500	°C/W
Operating and Storage Temperature Range	$T_j, T_{stg}$	-55 ~ +125	°C

### ELECTRICAL CHARACTERISTICS (Ta=25°C unless otherwise specified)

Parameter	Symbols	BAT46WFL	Units
Reverse Breakdown Voltage at $I_R=100\mu A$ (NOTE 2)	$V_{(BR)R}$	100	V
Maximum Forward Voltage (NOTE 2)	$V_F$	0.45 1.0	V
Peak Reverse Current	$I_R$	0.3 0.5 1 2	$\mu A$
Diodes Capacitance	$C_T$	20 12	pF

#### NOTES:

- ( 1 ) Part mounted on FR-4 board with recommended pad layout.  
( 2 ) Short duration pulse test used to minimize self-heating effect.



Fig.1 Power Derating Curve

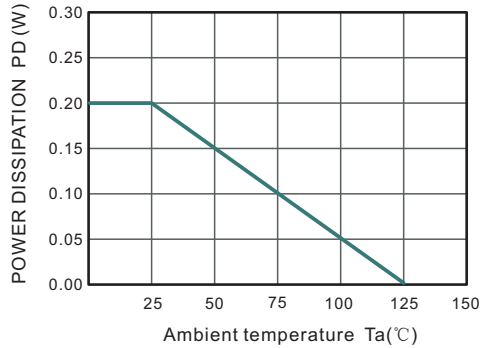

Fig.2 Typical Reverse Characteristics

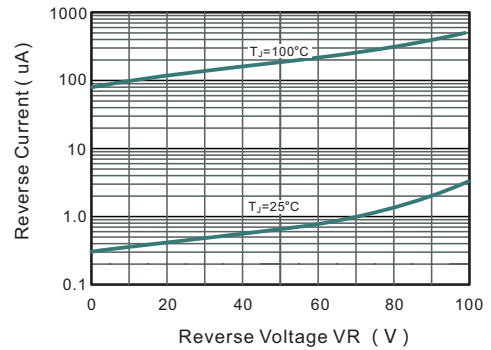

Fig.2 TYPICAL FORWARD VOLTAGE

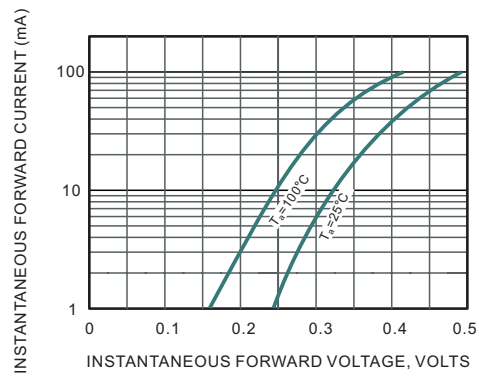

Fig.3 Typical Junction Capacitance

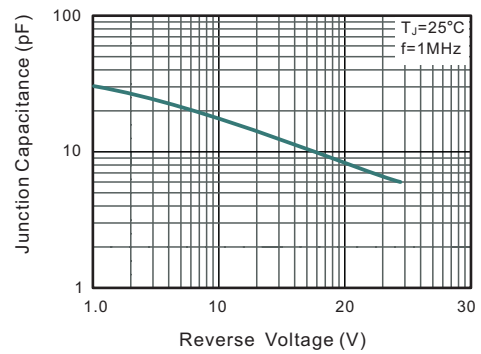

Fig.5 Maximum Non-Repetitive Peak Forward Surge Current

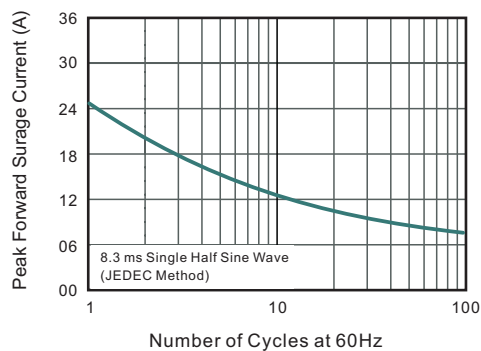
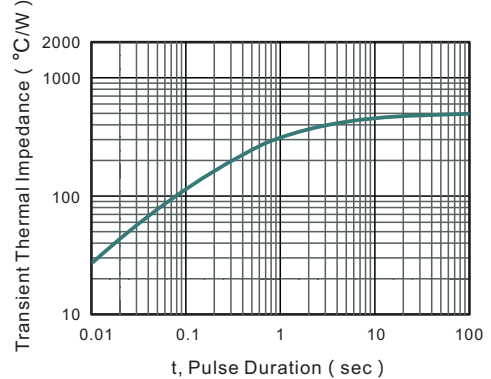

Fig.6 Typical Transient Thermal Impedance





**PACKAGE OUTLINE**

Plastic surface mounted package; 2 leads

SOD-323FL

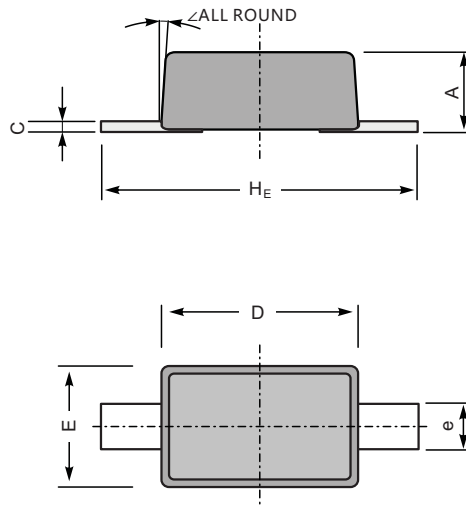

UNIT		A	C	D	E	e	H <sub>E</sub>	∠
mm	max	1.0	0.25	1.8	1.35	0.4	2.7	8°
	min	0.8	0.05	1.6	1.15	0.25	2.3	
mil	max	39	9.8	71	53	18	106	
	min	31	2.0	63	45	10	91	

**The recommended mounting pad size**

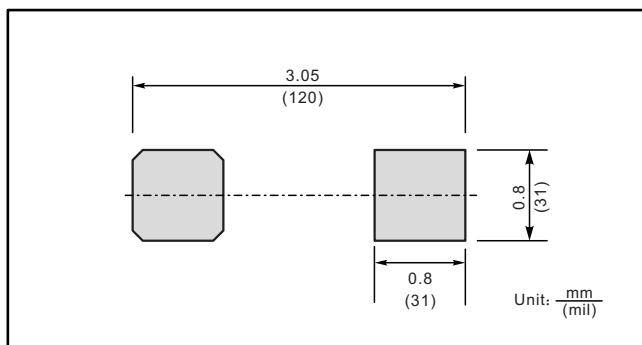

**Marking**

Type number	Marking code
BAT46WFL	S9